

**KIT LIG: 010..70**  
**015**  
**015..M**

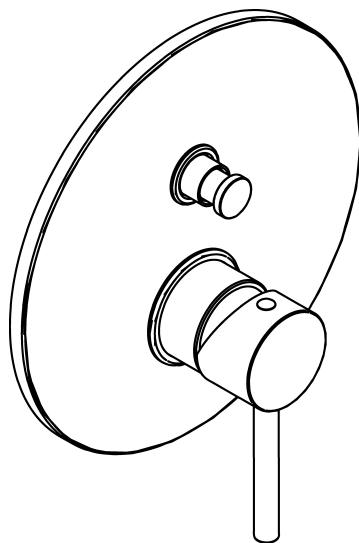

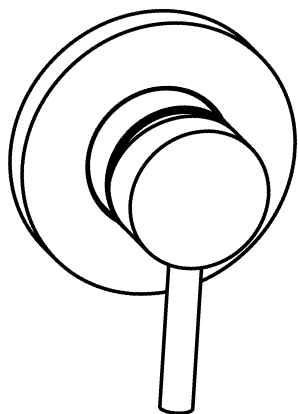

## ITALIANO

- L'installazione deve essere eseguita in conformità alle presenti istruzioni, alle norme edilizie e di sicurezza vigenti e a quelle relative agli impianti idraulici.
- Controllare il prodotto installato ad intervalli regolari per assicurarsi che non ci siano perdite o parti instabili.
- Tenere fuori dalla portata dei bambini. Alcune piccole componenti potrebbero essere ingerite.

## ENGLISH

- The installation must be carried out in compliance with current manual, building and safety regulations, as well as with the applicable plumbing standards. All required safety precautions must be observed.
- Periodically inspect the installed product to ensure there are no leaks or unstable parts, and take immediate action if any irregularities are detected.
- Keep out of reach of children. Small pieces that can be a choking hazard for young children.

**In caso di necessità contattare /  
In case of need contact:**

**Rubinetteria Paffoni S.p.A.**

**Via Soriso, 2**

**28076 - Pogno (NO)**

**Tel. +39 0322 97321/2**

**email: [ufficio.tecnico@paffoni.it](mailto:ufficio.tecnico@paffoni.it)**



Gestione imballaggi  
inquadrare il QR code

Packaging disposal  
scan the QR code

# 1

Montaggio  
Assembly

EN1717

Prima di chiudere  
il muro eseguire lo  
spurgo e la prova di  
pressione

Before concluding  
the wall finishing  
operation make pur-  
ge and  
pressure test

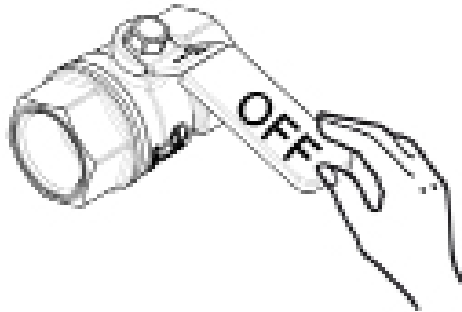
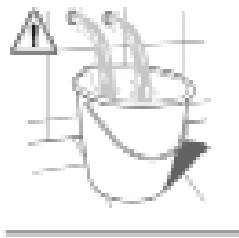

$65 \pm 5^{\circ}\text{C}$

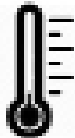

$15 \pm 5^{\circ}\text{C}$

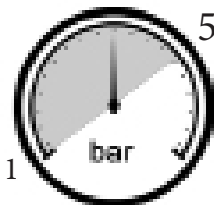

MIN - MAX



OK

Fissaggio Leva  
Fixing Lever

---

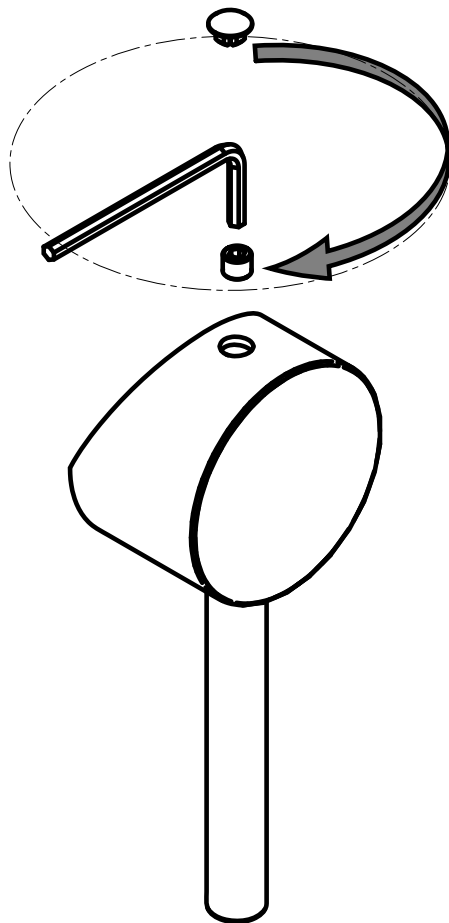

**2 a**

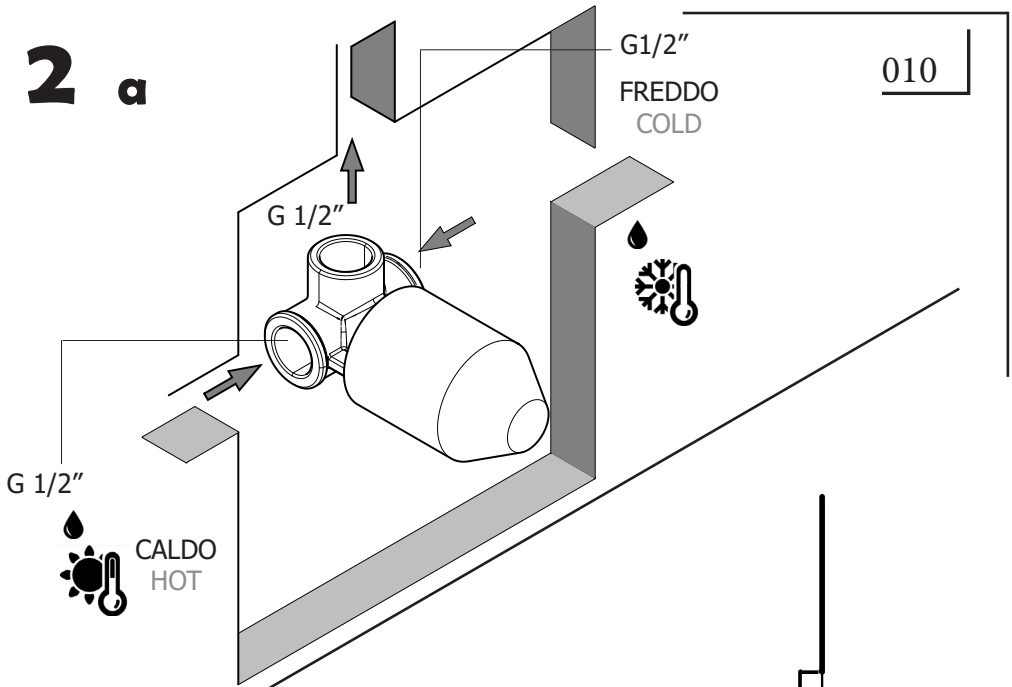

010

**c**

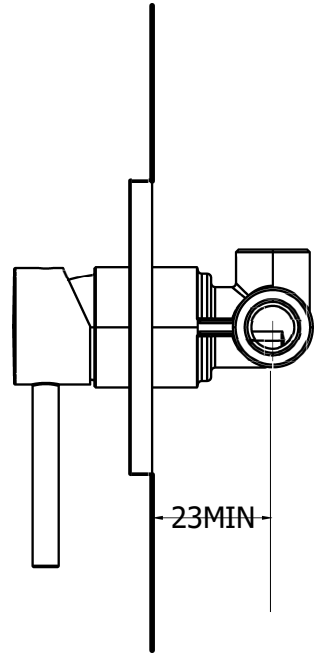
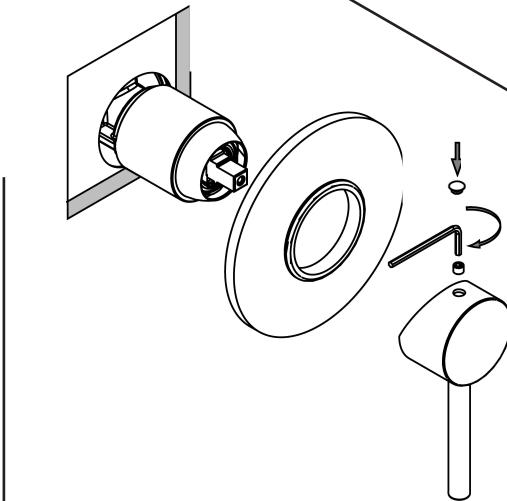

**3**

Rispettare le uscite e non rimuovere i tappi  
Respect the outlets and don't remove the plug

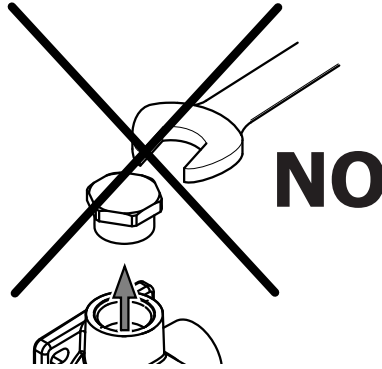

**a**

015

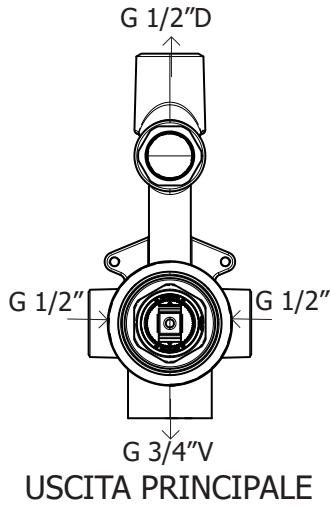

**b**

015

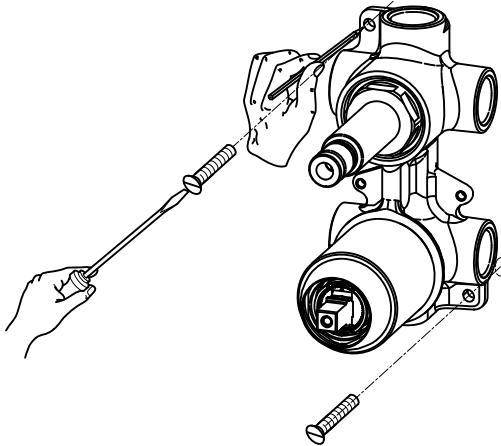

**c**

015

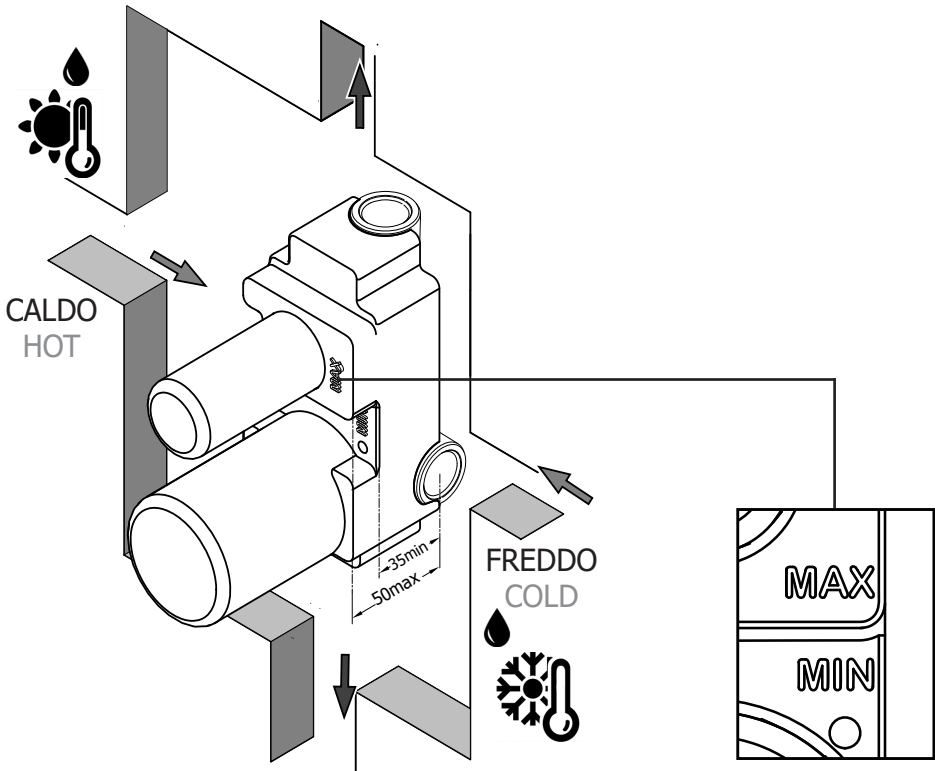

**d**

015

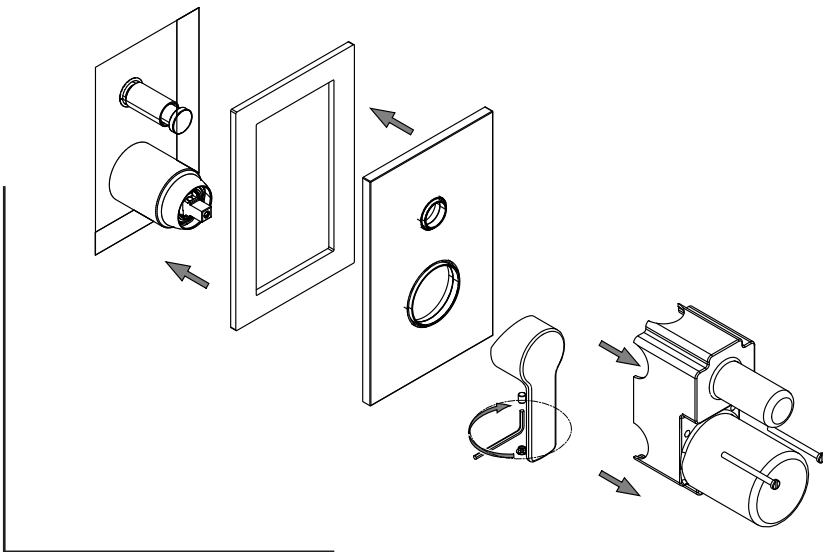

# F

## Funzionamento e regolazione deviatore Diverter working and setting



Controlla di aver impostato correttamente  
l'uscita superiore A quindi fissare la maniglia  
Check to set up accurately A upper outlet and  
than fix handle

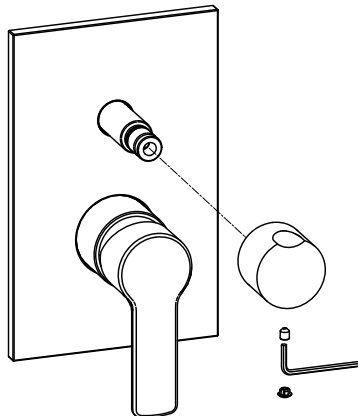
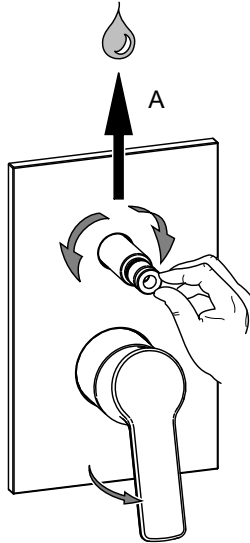

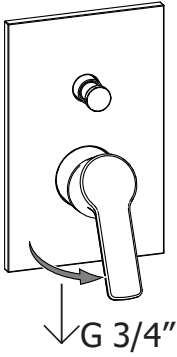

**A**

**B**

↑ G 1/2"

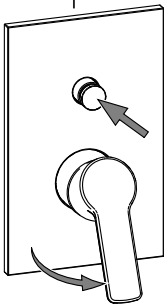

**M** Manutenzione  
Service

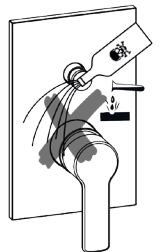
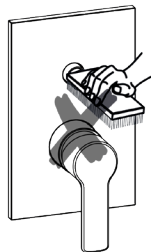
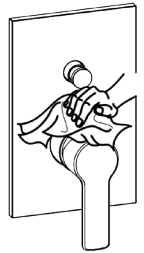
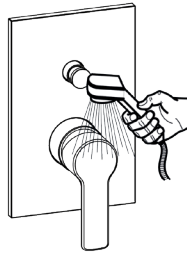
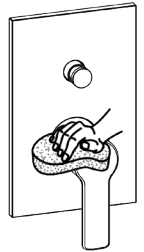
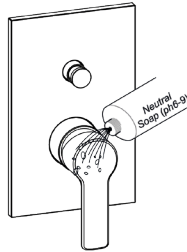



# Sostituzione Cartuccia

## How to replace Cartridge

**a**

Per tutte le serie  
For all series

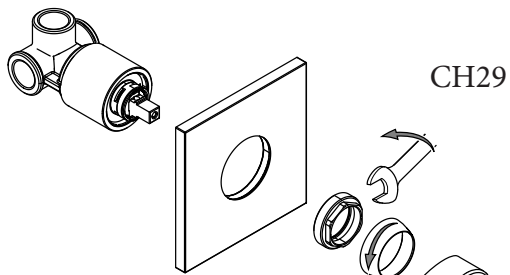

**b**

# Sostituzione Deviatore

## How to replace Diverter

Solo per Elys  
Only for Elys

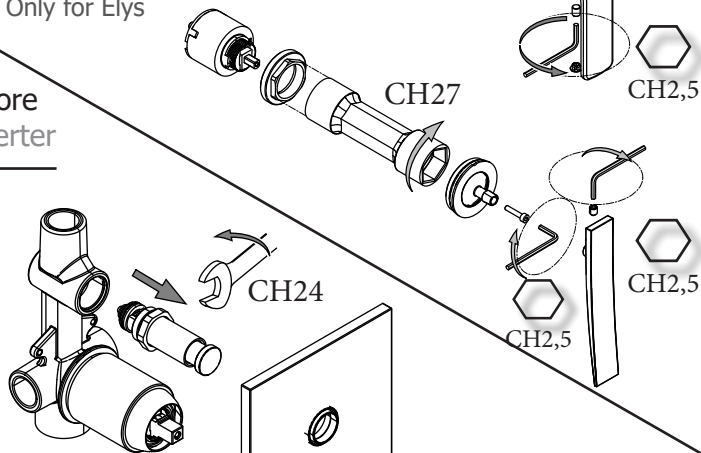

**c**

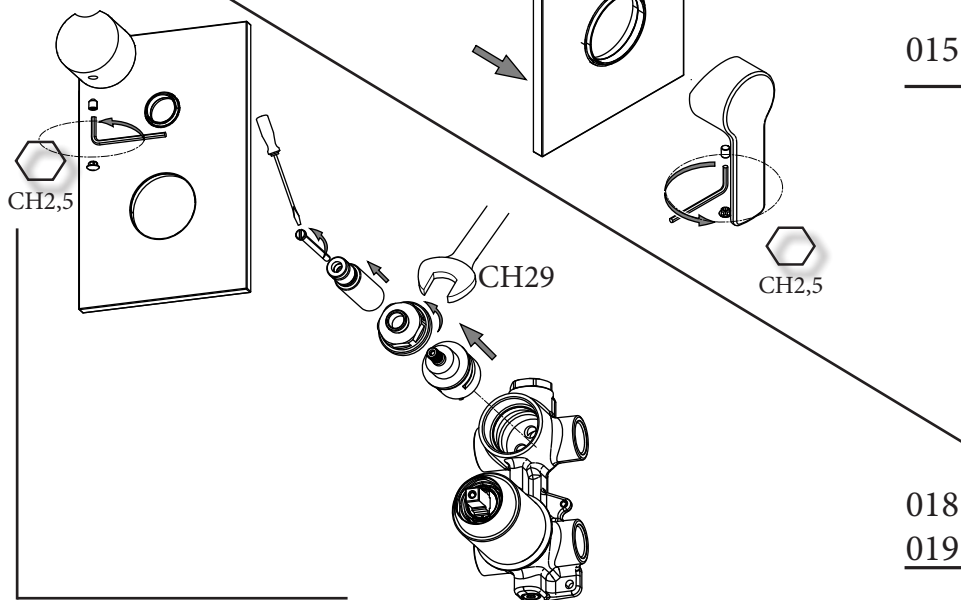

ITALIANO: Legge n.166/2009 del 25 settembre 2009 - Per quanto previsto dalla legge si dichiara che alcuni componenti di questo prodotto potrebbero essere di importazione extra UE. Gli stessi vengono testati, assemblati e collaudati all'interno del nostro stabilimento prima del loro utilizzo. ENGLISH: By law n. 166 / 2009 dd. 25th September 2009 - As by law enacted we state that some components of this product could be imported from extra-EU countries. They are checked, assembled and tested within our factory before being used.





# ZDUP

094..

095..

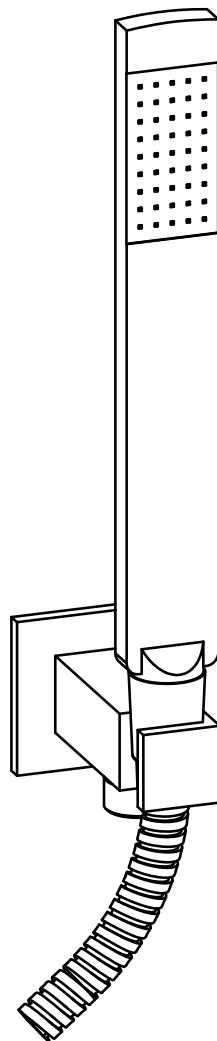
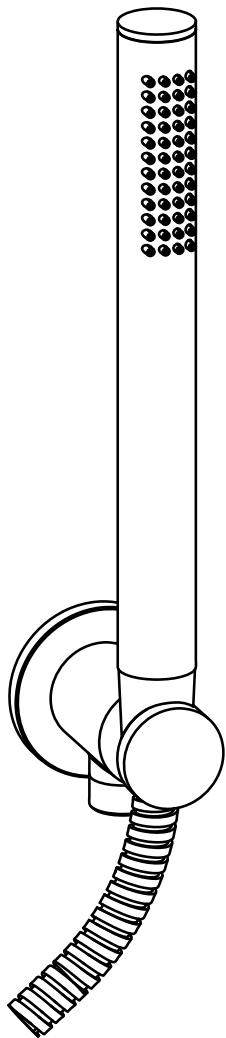

# 1

Montaggio  
Assembly



  $65 \pm 5^\circ\text{C}$

  $15 \pm 5^\circ\text{C}$



# 2

094..

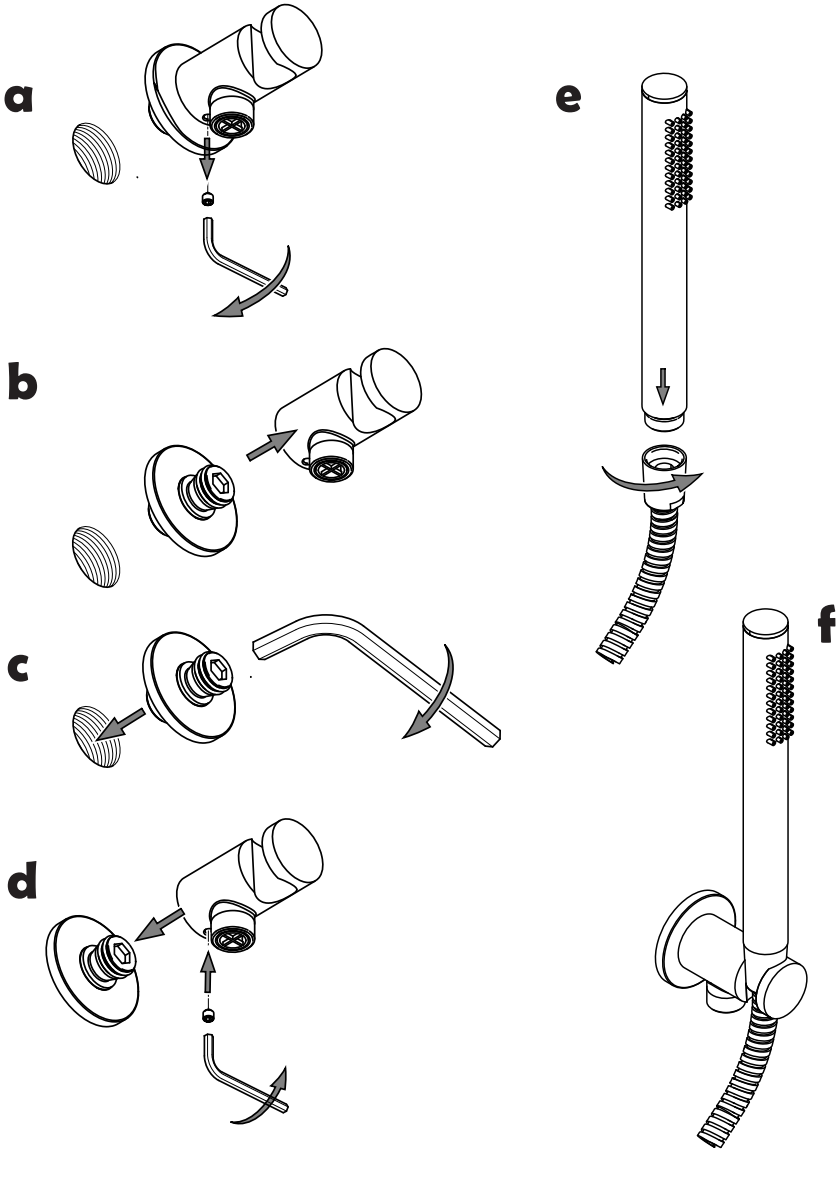

# 3

**a**

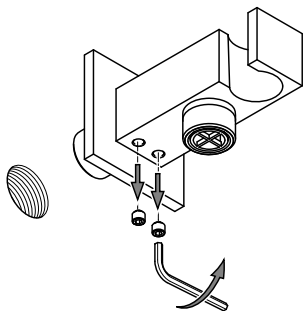

**b**

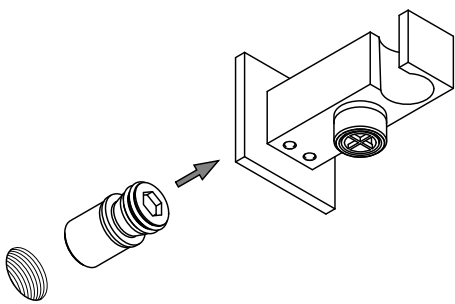

**c**

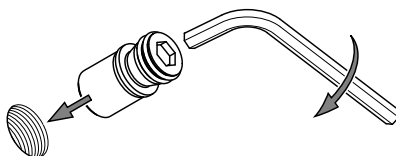

**d**

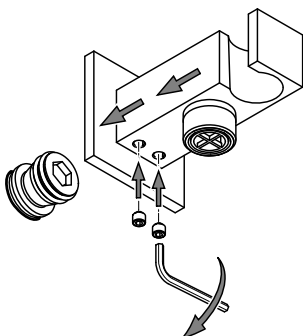

**e**

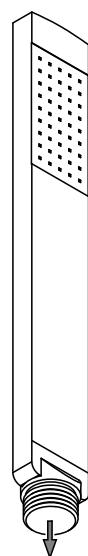

**f**

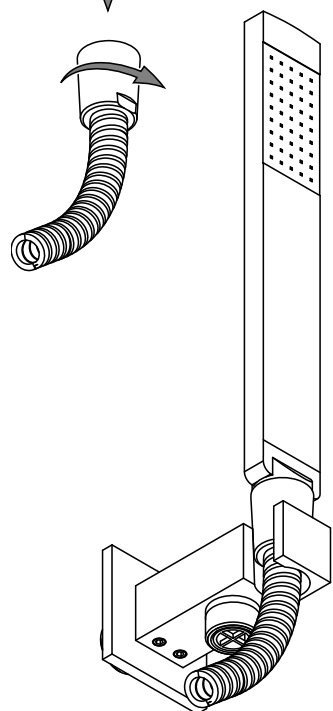

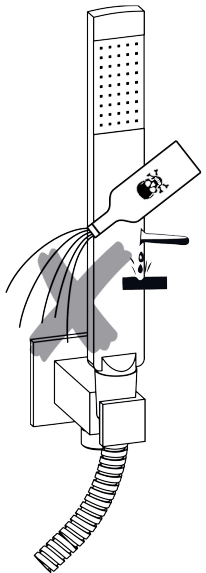
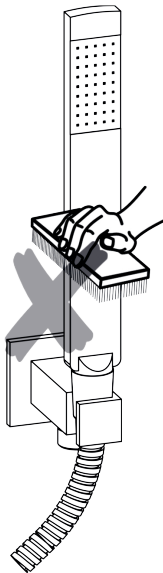
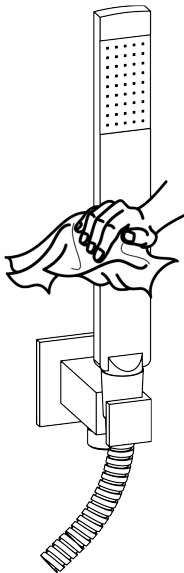
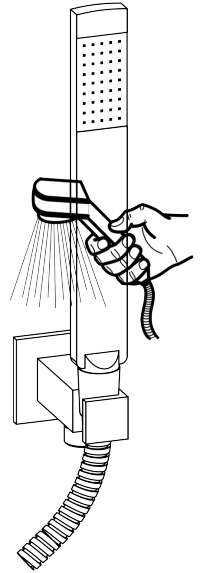
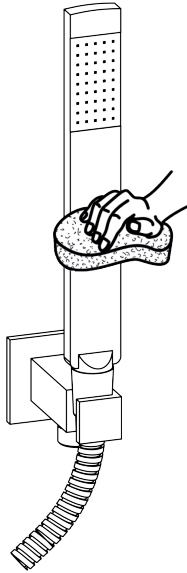
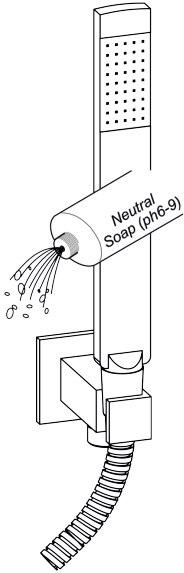

# ZSOF

029 ARIZONA	010
030 ISCHIA	015
031 ALABAMA	016
032 OREGON	017
046 BELINDA	018
075 SYNCRO	034
077 BERRY	035
074 MASTER	038
078 SYNCRO KING	061
079 MASTER KING	062
080 BERRY KING	063
081 NIRVANA	063..350
082 TURBO	064
091 CITY	065
092 WIND	073
093 BAHAMAS	090
094 JAMAICA	118
095 HAWAI	119
096 ZANZIBAR	306 Inox tech
101 MASTER SPECIALE	307 Inox tech
102 BLANC	308 Inox tech
103 ENERGY	309 Inox tech
104 ORIGINAL	
115 PANDA	

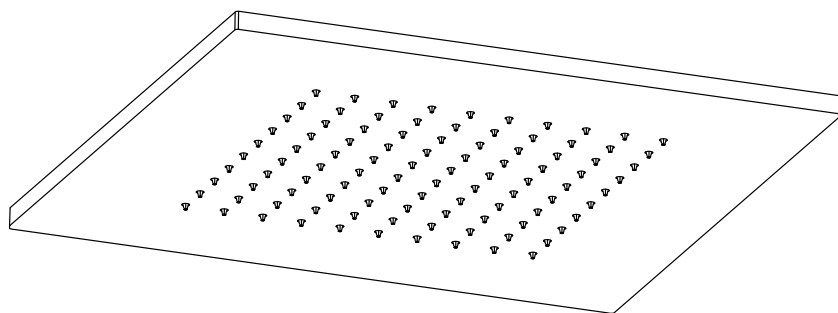

1

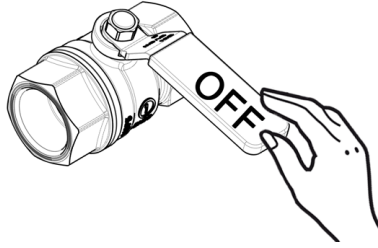

$65 \pm 5^\circ\text{C}$



$15 \pm 5^\circ\text{C}$

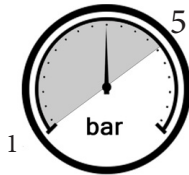

1

MIN - MAX



3

OK

$\Delta p$  MAX 1bar

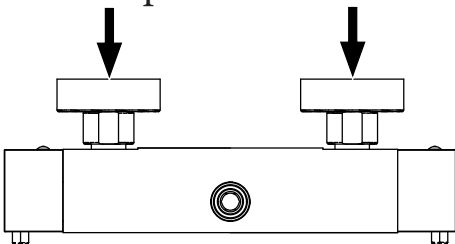

$\Delta p$ : differenza pressione in entrata  
different inlet water pressure

**2**

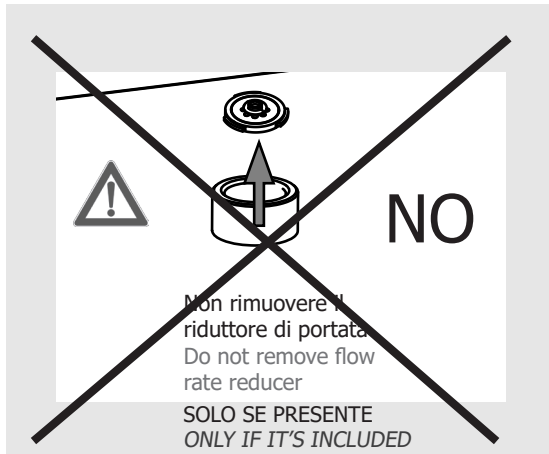

**3**

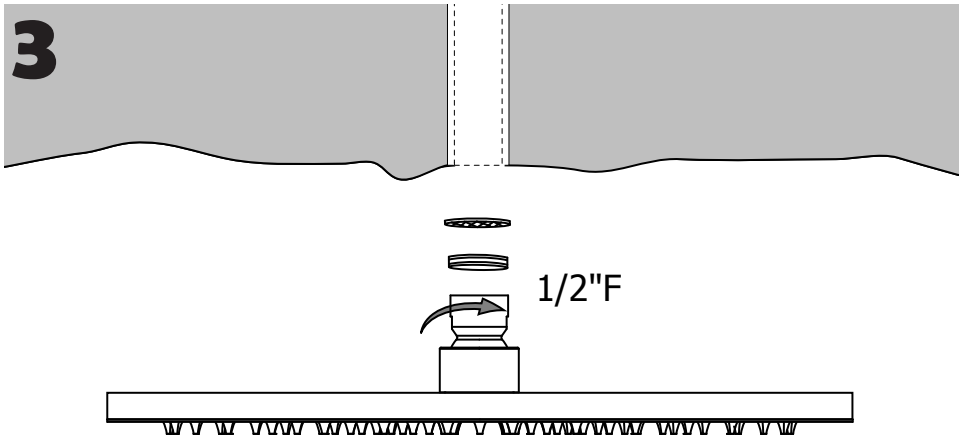

**4**

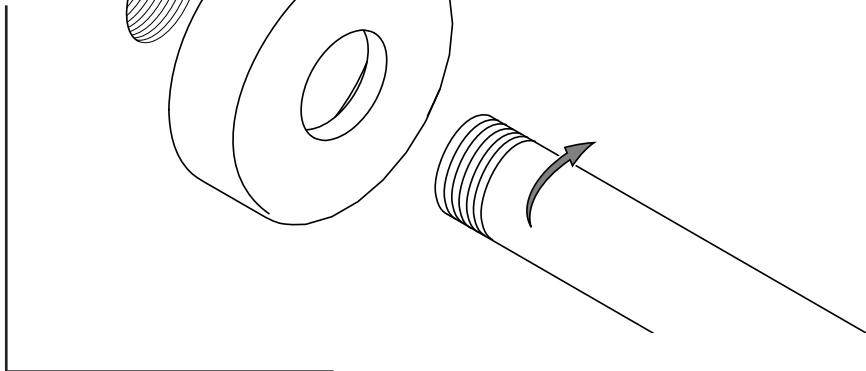

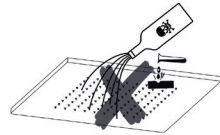
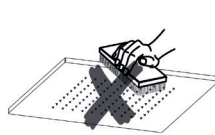
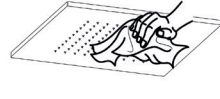
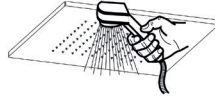
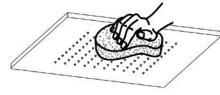
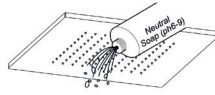

**P** Pulizia  
Cleaning

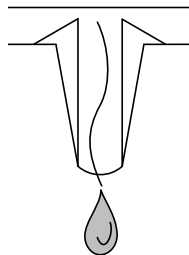
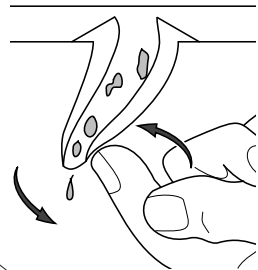
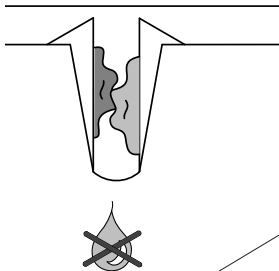
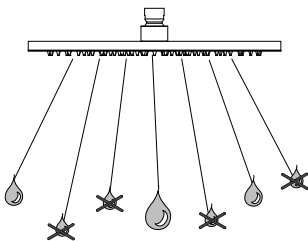



## **ITALIANO**

L'installazione deve essere eseguita in conformità alle norme edilizie e di sicurezza vigenti e a quelle relative agli impianti idraulici.

## **ENGLISH**

The installation must be carried out in compliance with current building and safety regulations, as well as with the applicable plumbing standards. All required safety precautions must be observed.



### **ITALIANO**

Controllare il prodotto installato ad intervalli regolari per assicurarsi che non ci siano perdite o parti instabili.

### **ENGLISH**

Periodically inspect the installed product to ensure there are no leaks or unstable parts, and take immediate action if any irregularities are detected.



**ITALIANO**

Tenere fuori dalla portata dei bambini.

**ENGLISH**

Keep out of reach of children.

