

010..

015..

018..

019..

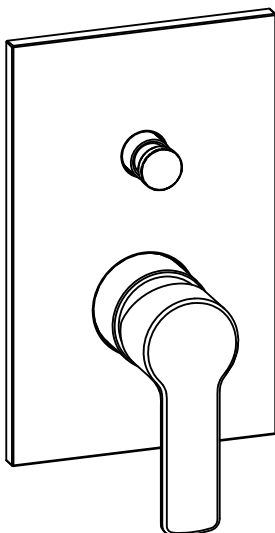

**COMPATIBILITY:**

ELY	DU
EL/EF	ND
LES/LEC/LEA	NT
BR	PI
BI	APM
LIG	FA/GI
RIN/WS	TA
CA	TI
SK	RO
SY	LM
GR	JO/JK
RED	OG
DE	BLU
FOX	
JL	

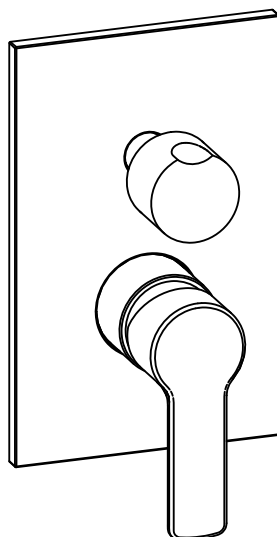



## ITALIANO

- L'installazione deve essere eseguita in conformità alle presenti istruzioni, alle norme edilizie e di sicurezza vigenti e a quelle relative agli impianti idraulici.
- Controllare il prodotto installato ad intervalli regolari per assicurarsi che non ci siano perdite o parti instabili.
- Tenere fuori dalla portata dei bambini. Alcune piccole componenti potrebbero essere ingerite.

## ENGLISH

- The installation must be carried out in compliance with current manual, building and safety regulations, as well as with the applicable plumbing standards. All required safety precautions must be observed.
- Periodically inspect the installed product to ensure there are no leaks or unstable parts, and take immediate action if any irregularities are detected.
- Keep out of reach of children. Small pieces that can be a choking hazard for young children.

**In caso di necessità contattare /  
In case of need contact:**

**Rubinetteria Paffoni S.p.A.**

**Via Soriso, 2**

**28076 - Pogno (NO)**

**Tel. +39 0322 97321/2**

**email: [ufficio.tecnico@paffoni.it](mailto:ufficio.tecnico@paffoni.it)**



Gestione imballaggi  
inquadrare il QR code

Packaging disposal  
scan the QR code

# 1

Montaggio  
Assembly

EN1717

Prima di chiudere  
il muro eseguire lo  
spurgo e la prova di  
pressione

Before concluding  
the wall finishing  
operation make pur-  
ge and  
pressure test

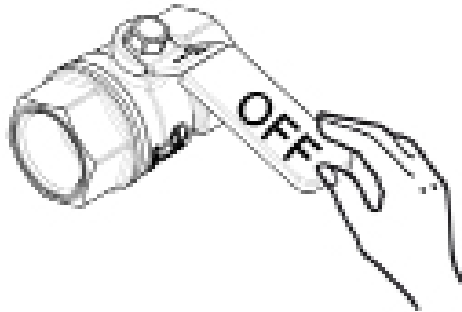
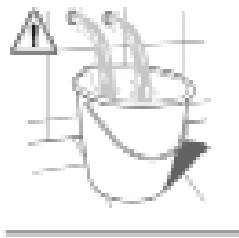

$65 \pm 5^{\circ}\text{C}$

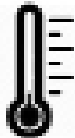

$15 \pm 5^{\circ}\text{C}$

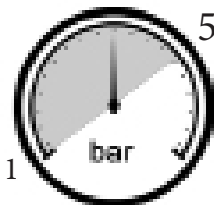

MIN - MAX



OK

Fissaggio Leve  
Fixing Levers

**a**

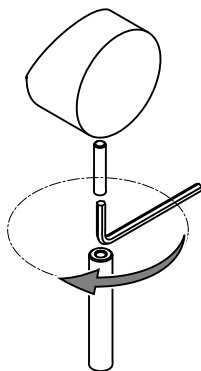

**b**

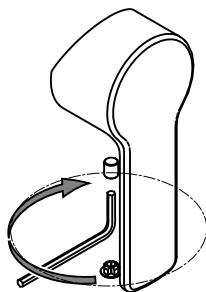

**c**

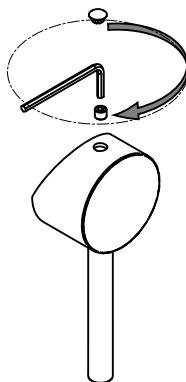

**d**

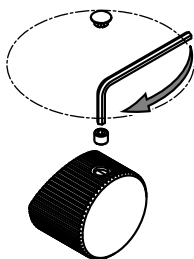

**e**

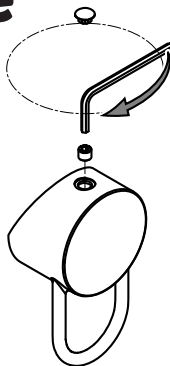

# 2 a

010

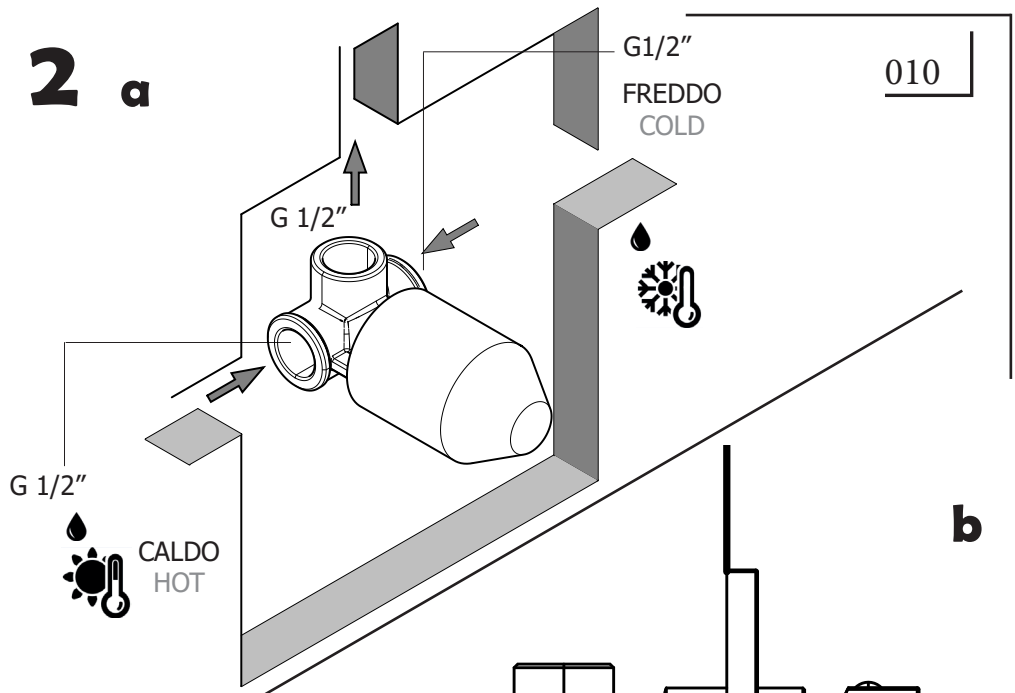

# b

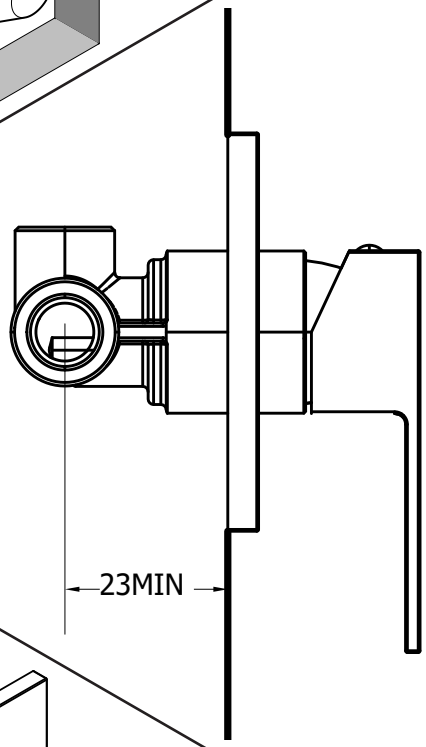

# c

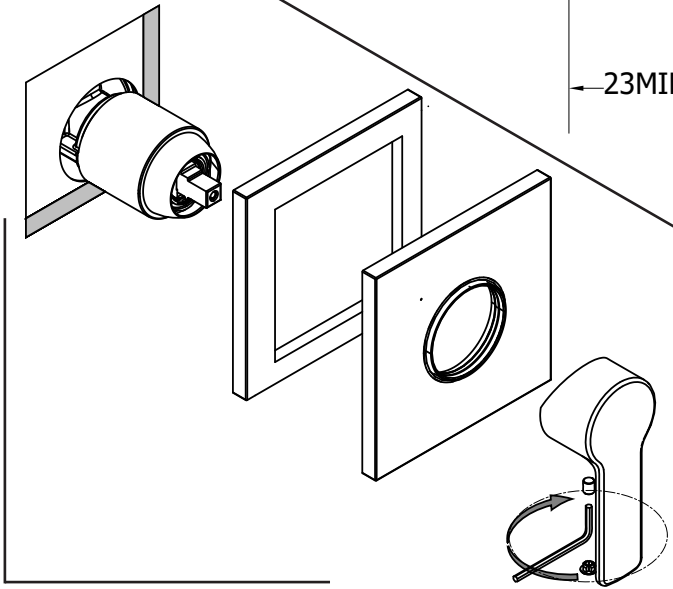

**3**



Rispettare le uscite e non rimuovere i tappi  
Respect the outlets and don't remove the plug

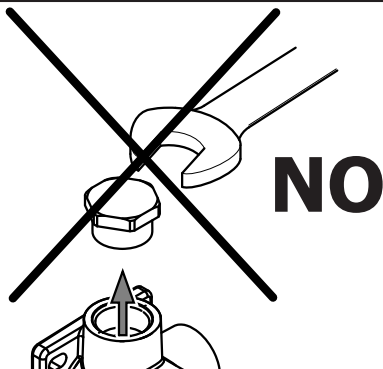

**a**

015

018

019

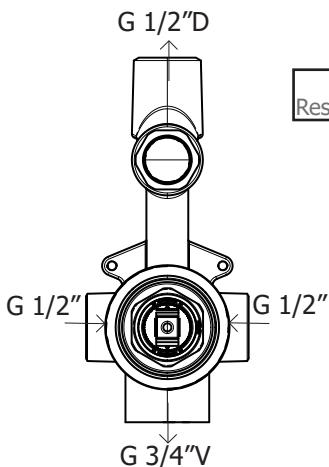

  
Rispettare le uscite e non rimuovere i tappi  
Respect the outlets and don't remove the plug

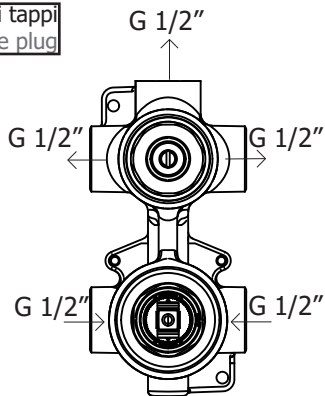
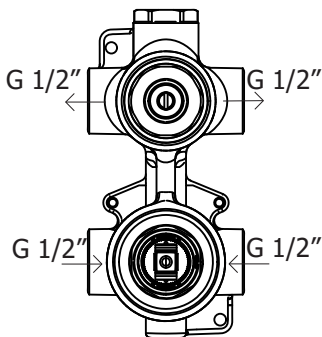

USCITA PRINCIPALE

**b**

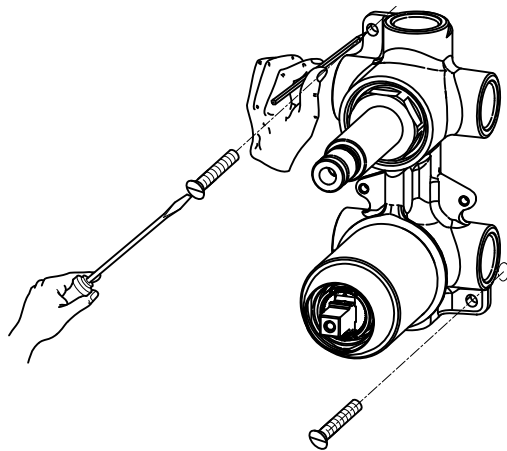

015

018

019

**c**

015

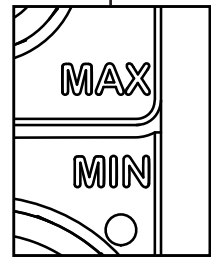
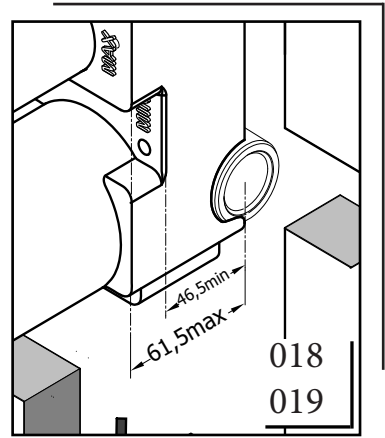
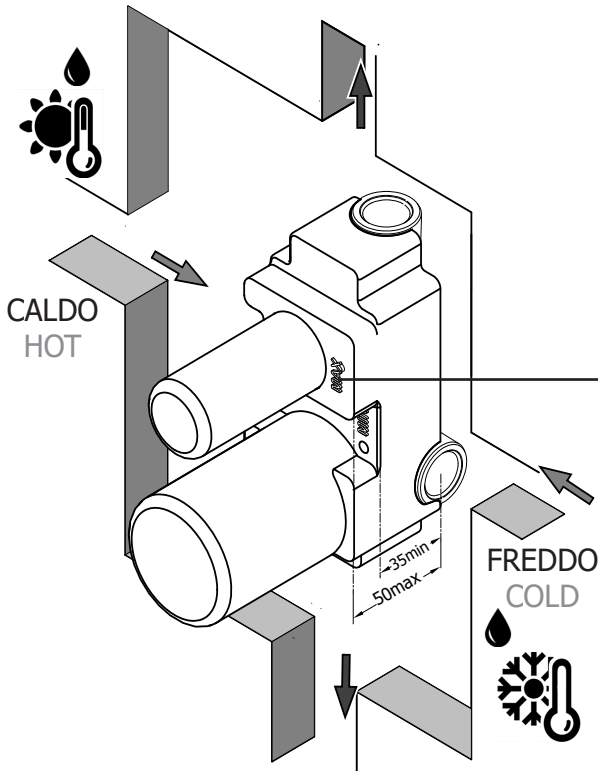

**d**

015

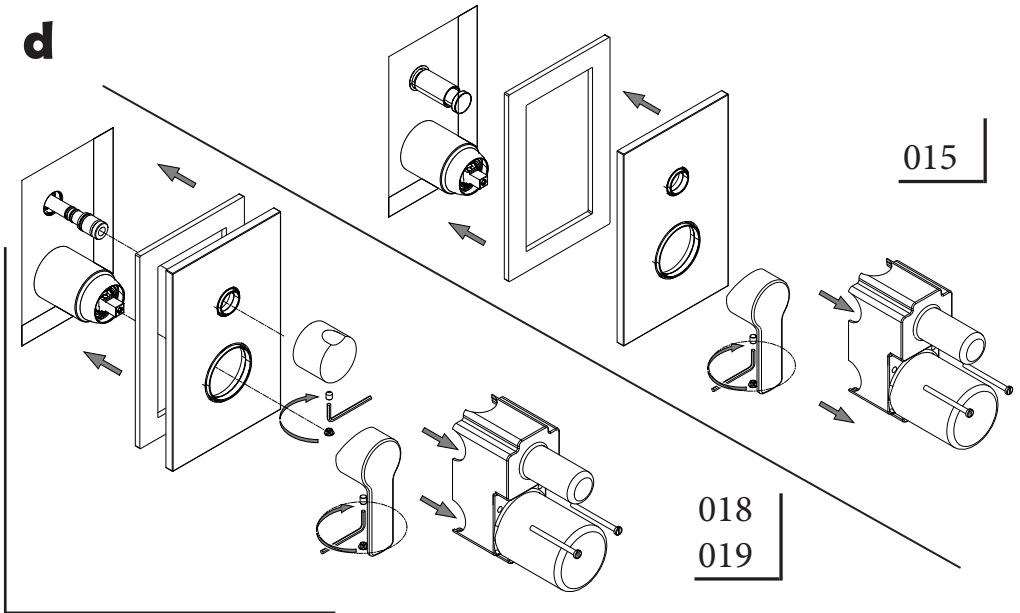

# F

## Funzionamento e regolazione deviatore Diverter working and setting

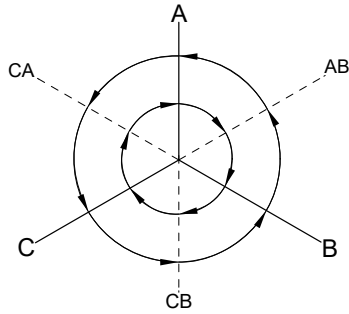

### Posizioni maniglia e selezione uscite Handle positions and outlets selection

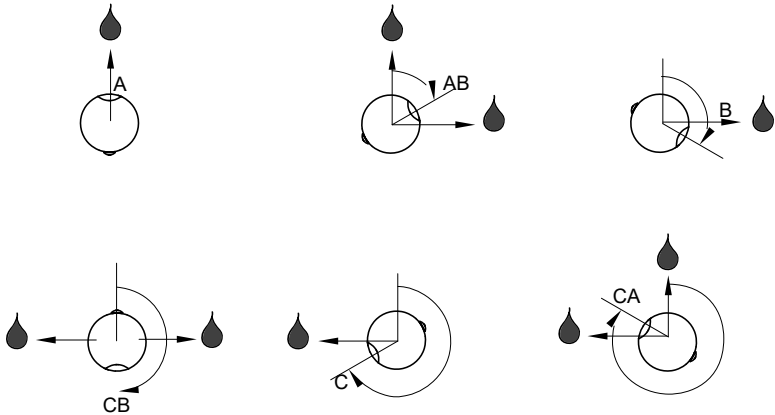

Controlla di aver impostato correttamente l'uscita superiore A quindi fissare la maniglia  
Check to set up accurately A upper outlet and then fix handle

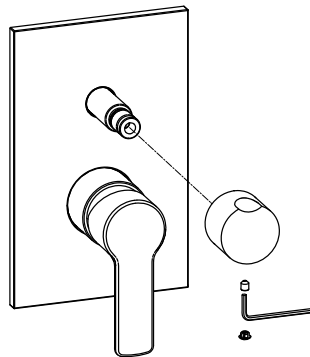
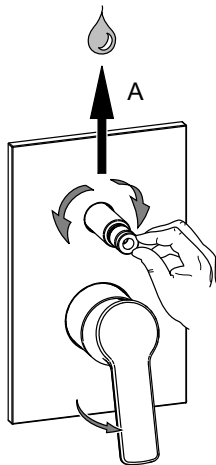

018

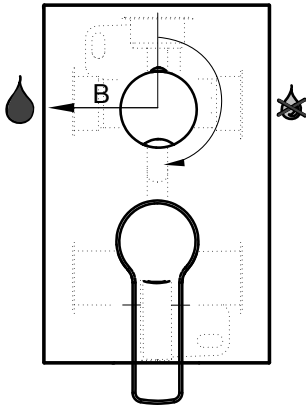
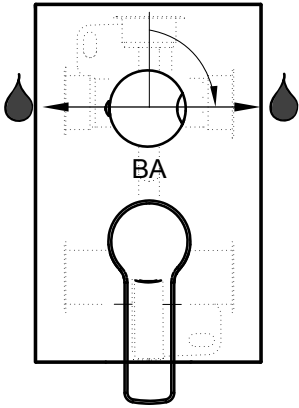
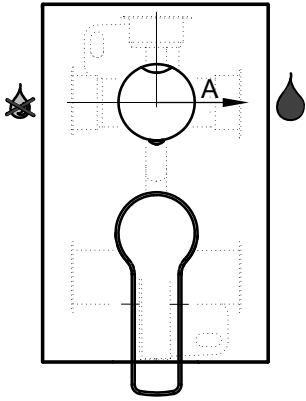

015

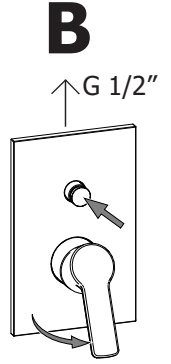
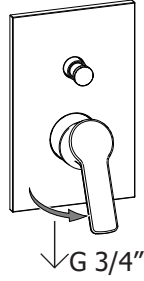

**M** Manutenzione  
Service

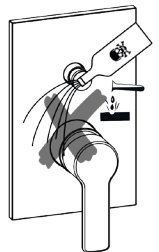
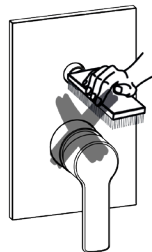
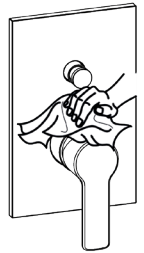
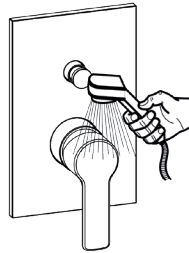
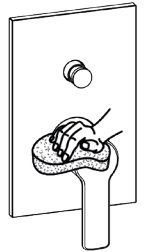
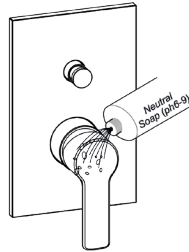



# Sostituzione Cartuccia

## How to replace Cartridge

**a**

Per tutte le serie  
For all series

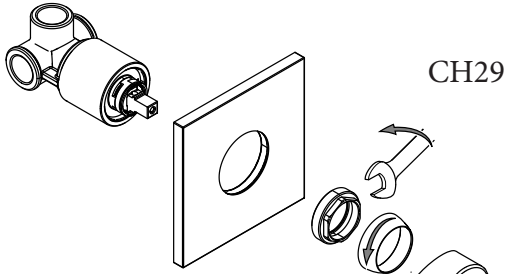

**b**

# Sostituzione Deviatore

## How to replace Diverter

Solo per Elys  
Only for Elys

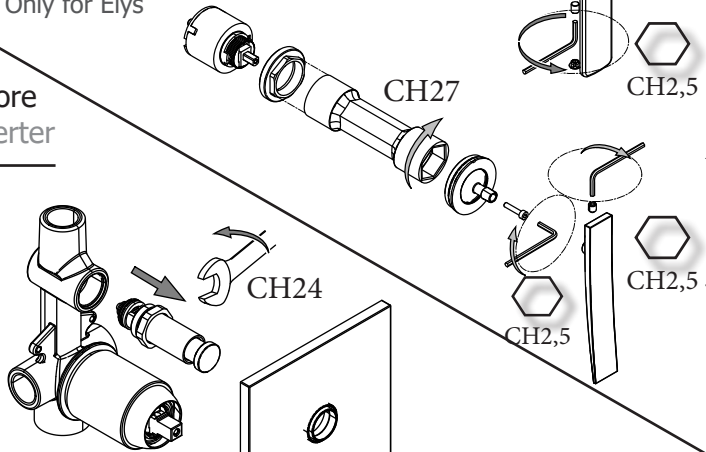

**c**

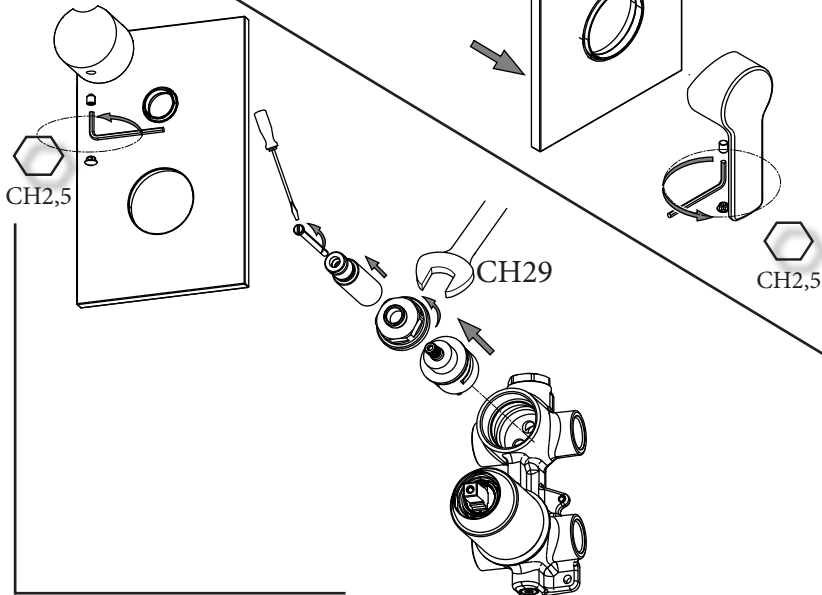

015

018

019

ITALIANO: Legge n.166/2009 del 25 settembre 2009 - Per quanto previsto dalla legge si dichiara che alcuni componenti di questo prodotto potrebbero essere di importazione extra UE. Gli stessi vengono testati, assemblati e collaudati all'interno del nostro stabilimento prima del loro utilizzo. ENGLISH: By law n. 166 / 2009 dd. 25th September 2009 - As by law enacted we state that some components of this product could be imported from extra-EU countries. They are checked, assembled and tested within our factory before being used.



